



BOTANIC
GARDENS
OF SYDNEY

Public Art Project – Welcome to Country

EOI open from 12 February – 8 March 2024



ACKNOWLEDGEMENT OF COUNTRY

We acknowledge that the Gardens are significant historical, ceremonial and traditional trade grounds for the local Gadigal, Dharawal and Darug peoples.

We pay respect to all Elders and Traditional Custodians of these lands and waters on which our Gardens sit, including their continuous custodianship, protection and management of these sacred lands.

We are committed to celebrating and promoting First Nations Science, Knowledge and Cultural Practices through collaboration, programs and protocols. The Gardens entwine people with place and plants, deepening understanding, appreciation and cultural respect through Connection to Country.

IMAGE: *Yurrabirong (People of This Place)* was carved by Glen Timbery and Uncle Vic Simms. They transformed the trunk of a remnant Red Gum that has been standing on Gadigal land for over two hundred years.



BOTANIC GARDENS OF SYDNEY

Botanic Gardens of Sydney is custodian of the Royal Botanic Garden Sydney, Australian Botanic Garden Mount Annan, Blue Mountains Botanic Garden Mount Tomah, The Domain Sydney and the Australian Institute of Botanical Science.

The garden sites have been significant for First Nations peoples for millennia and continue to be central to culture and community across Sydney today. They hold invaluable living collections of plants, are the setting for important research, science and conservation, and are loved as places of education, enjoyment and wellbeing.

Connection to Country is at the heart of Botanic Gardens of Sydney. We work to better understand and protect plants, particularly Australian native plants and their habitats. We provide spaces for people to connect with nature for solace, celebration and inspiration. We work with First Nations peoples to promote culture, preserve local habitats, decolonise our collections and develop more sustainable land management practices.



A close-up photograph of a tree trunk. The left side shows smooth, light-colored bark. The right side shows dark, charred, and peeling bark. A scorpion is visible on the dark, damaged bark. The text "THE PROJECT" is overlaid in white on the right side of the image.

THE PROJECT



THE OPPORTUNITY

Botanic Gardens of Sydney will commission an Artist to produce a sculptural artwork embodying Welcome to Country on Gadigal Land.

The commissioning of a First Nations Artist for this work recognises and celebrates the deep cultural significance of the Garden site to First Nations peoples.

We are seeking expressions of interest from artists who have strong connections to Gadigal Country and/or the Gadigal Community and other First Nations Countries and Communities across the wider Sydney region.

The selected Artist will produce their design, which will be installed in the entrance garden at the front of Botanic Gardens of Sydney headquarters on Mrs Macquaries Road, Royal Botanic Garden Sydney.



PROJECT TIMELINE

12 February 2024	EOI opens
20 Feb 2 – 3.30pm 22 Feb 10.30 – 12noon	Artist site-visits to view artwork location
8 March 2024	EOI closes at 5pm
14 March 2024	Shortlisted Artists interviews
18 March 2024	Successful Artist advised and contract signed
20 – 29 March 2024	Stage 1 – Design finalisation 1. Consultation with Botanic Gardens of Sydney and Gadigal Traditional Custodians 2. Installation method sign-off 3. Final design approval
30 March – 12 May 2024	Stage 2 – Production 4. Material source and purchase 5. Artwork production/fabrication
Week of 13 May 2024	Stage 3 – Installation 6. Artwork transportation to site (by us) 7. Installation (by us and the Artist)



CONTRACT

Once the EOI is complete, the selected Artist will enter into a commissioning agreement contract with Botanic Gardens of Sydney (Legal name: Royal Botanic Gardens and Domain Trust). The contract was developed in consultation with Terri Janke and Company and includes best-practice Indigenous Cultural and Intellectual Property protocols.

ARTIST FEE

An Artist Fee of \$15,000 (ex GST) will be paid in three installments:

1. on signing the contract,
2. on acceptance of final design, and
3. on delivery and installation of completed artwork.

The Artist Fee is inclusive of all sculpture production costs including materials, tools and fabrication.

Botanic Gardens of Sydney will cover costs for an engineering consultant if needed, artwork transport and installation onsite. This process will be managed in consultation with the Artist.

The background of the slide is a photograph of a bright blue sky filled with soft, white, fluffy clouds. The clouds are scattered across the frame, with some appearing more dense and others more wispy. The overall tone is bright and airy.

EXPRESSION OF INTEREST

SELECTION PROCESS

1. Artists must respond to this EOI by **5pm 8 March 2024**.
2. Artist applications will be assessed against the Selection Criteria.
3. A short list of artists will be invited for individual interviews with the Selection Panel, to discuss their design in detail.
4. One design will be selected for production.
5. The successful Artist will enter into a commissioning agreement contract with the Royal Botanic Gardens and Domain Trust to produce and deliver their design.



SELECTION CRITERIA

1. The Artist should have a strong connection to Gadigal Country and/or the Gadigal Community and other First Nations Countries and Communities across the Sydney region.
2. Alignment to the Design Brief, including site-suitability.
3. Artistic experience and ability to deliver the work on time.
4. Artists must be of Aboriginal descent and reside in New South Wales.



SELECTION PANEL

Aunty Rhonda Dixon
Gadigal Traditional Custodian

Kalkani Choolburra
First Nations Learning Leader
Botanic Gardens of Sydney

Damian Wrigley
Manager, Living Collections and Conservation
Botanic Gardens of Sydney

Sophie Daniel
Manager Interpretation and Placemaking
Botanic Gardens of Sydney

Wes McLeod
Programs Manager, Aboriginal and Torres Strait Islander Art
Art Gallery of New South Wales





DESIGN BRIEF



DESIGN BRIEF

1. The design will embody a Welcome to Country for Gadigal land, waters and sky.
2. The design will be a sculptural artwork made of natural materials that are found on Gadigal Country. (eg sandstone)
3. The design will have a strong connection to Gadigal Country, and incorporate the understanding that Botanic Gardens of Sydney reaches across many First Nations Countries across the wider Sydney region.
4. The design will be unique and site-specific.
5. The design will be appropriate in scale and form for the site, see plans and specifications on the next page.
6. The artwork will have a life-span of 10+ years, considering the outdoor, all-weather location.

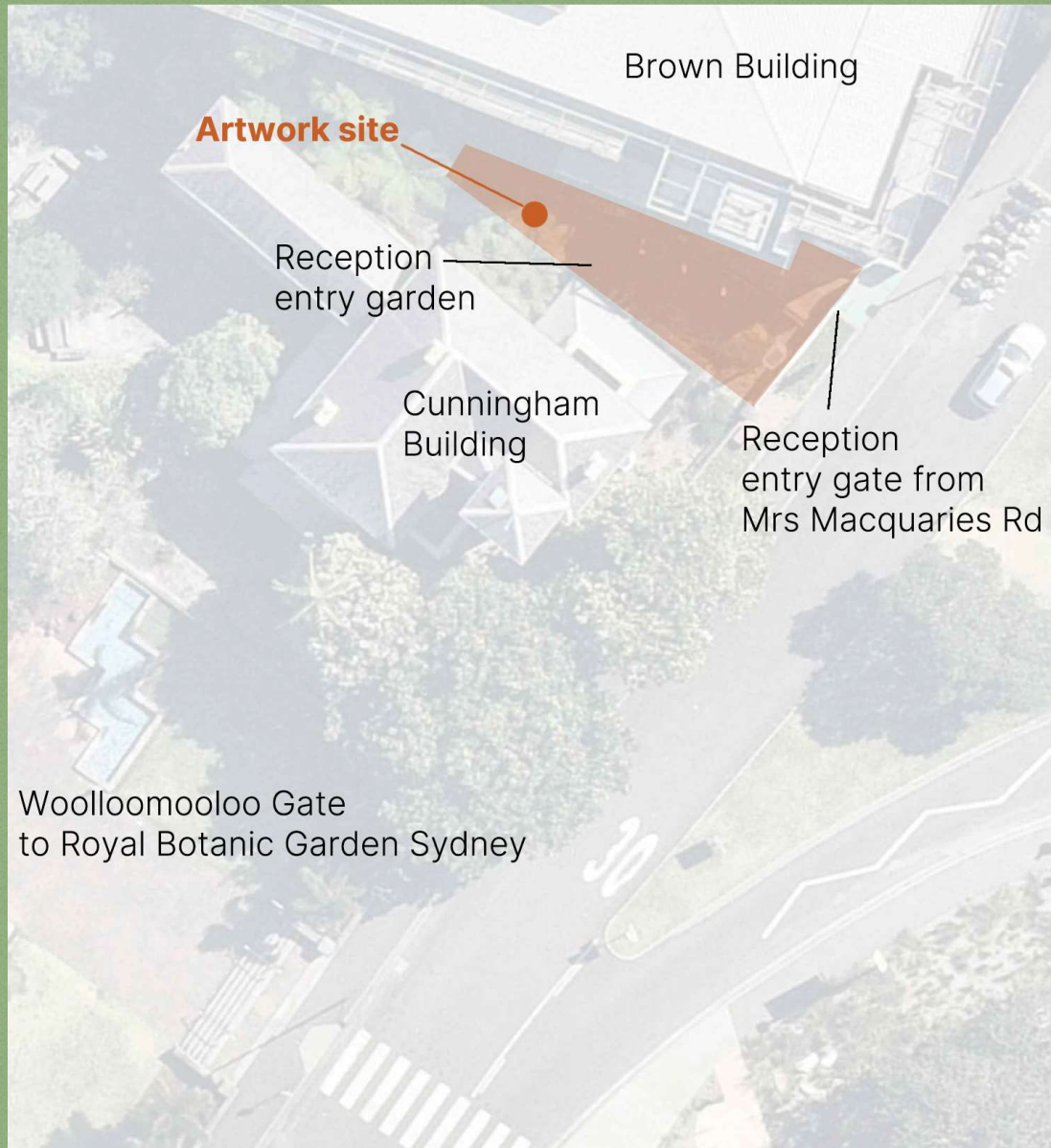

Brown Building

Artwork site

Reception
entry garden

Cunningham
Building

Reception
entry gate from
Mrs Macquaries Rd

Woolloomooloo Gate
to Royal Botanic Garden Sydney

ARTWORK SITE

The artwork will be installed on Gadigal Country in the Royal Botanic Garden Sydney, Mrs Macquaries Road, Sydney NSW.

The artwork will be located in the Reception entry garden area, between the Cunningham Building and the Brown Building.

SPECIFICATIONS

The artwork must have a maximum footprint of 1m x 1m and be no taller than 1.7m.

The design should respond to the artwork's position: It will be viewed from all angles – from the street, the pathway and from inside the adjacent buildings.

The design should specify footings to support and safely secure the artwork in place. This will be finalised by the Artist with an engineer (if needed) during the production phase. Botanic Gardens of Sydney will manage this process.

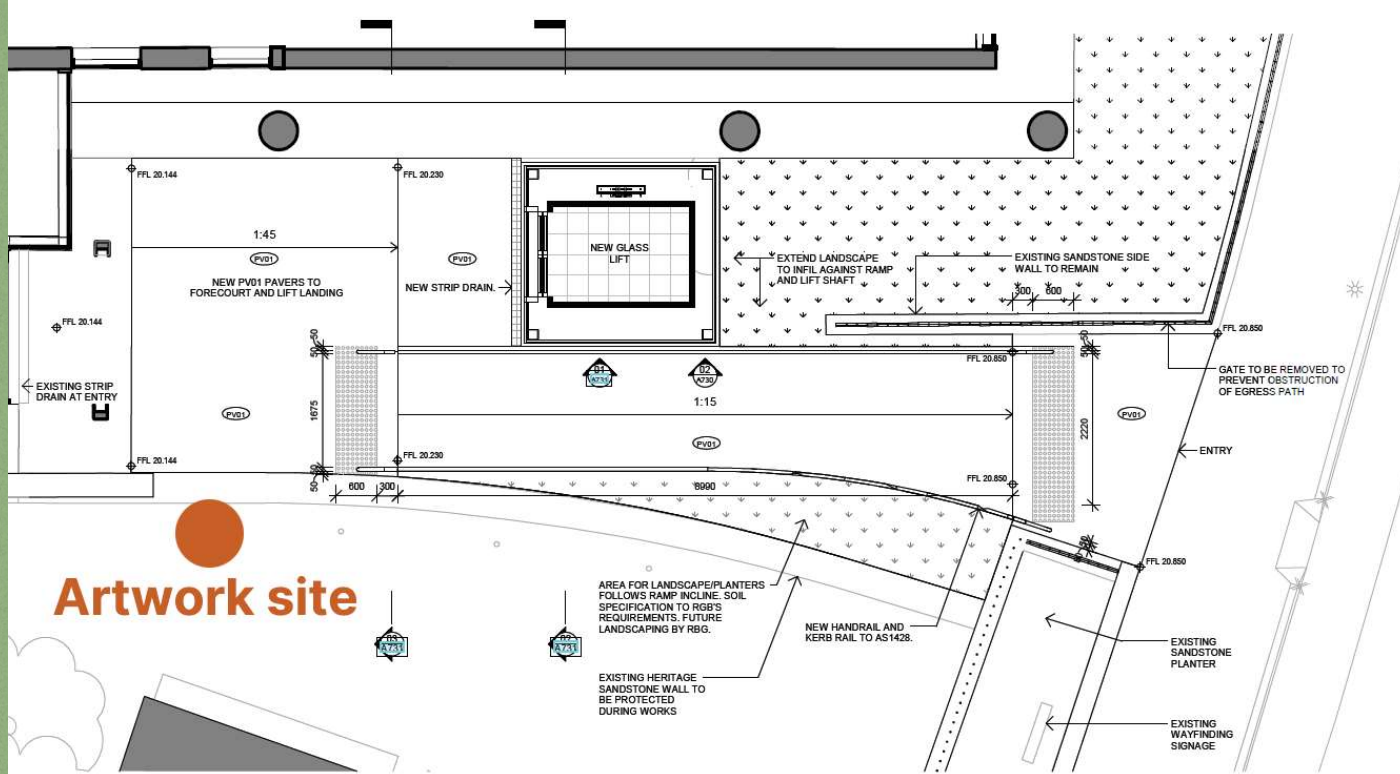

SITE PLAN - Reception Entry Garden

The artwork will be installed approximately ten metres inside the Mrs Macquaries Road entry gate. It will be to the left of the foyer entrance door.

The artwork will be installed on the southern side of the path, within a garden bed.

The garden bed is raised approximately 500mm higher than the adjacent pathway and is edged with a low sandstone wall.

The artwork will sit approximately 500mm back from the edge of the garden bed. The exact artwork orientation will be discussed by Botanic Gardens of Sydney and the Artist during the finalisation of the design.

EXTERNAL FINISHES

FC01: FIBRE CEMENT REPLACEMENT SHEETING. PAINT FINISH 'DULUX TERRA ROSE' TO MATCH EXISTING.

FC02: FIBRE CEMENT REPLACEMENT SHEETING. PAINT FINISH 'DULUX LUNETTE HALF' TO MATCH EXISTING.

BAL1: METAL BALUSTRADE. 'DULUX BLACK ACE' FINISH.

EMF1: MISCELLANEOUS METAL FRAMING AND TRIMS. 'DULUX BLACK ACE' FINISH.



GL01: NEW GLAZED WINDOW AND DOOR OPENINGS. FRAME FINISH ANODISED TO MATCH 'DULUX BLACK ACE'



EMF2: WOVENWELDED SOLID WIRE MESH BALUSTRADE INFILL. 'DULUX BLACK ACE' FINISH



EME3: WIRE MESH SCREEN. FINISH 'DULUX BLACK ACE'



TGI: TACTILE GROUND INDICATORS. STAINLESS STEEL WITH BLACK SLIP RESISTANT INLAY

PV01: LANDSCAPE PAVER. SURFACE GALLERY ASH BLACK-FLAMED.

GL02: NEW GLAZED LIFT. VERDIAN SUPERCLEAR SERAPHIC LAMINATED GLASS

HYDRANT BOOSTER CUPBOARD: DULUX BREWSTER GREEN TO MATCH EXISTING SURROUNDING FENCE



Approximate
artwork position

Reception
Entrance

SITE VISIT

This image shows the approximate artwork location in the garden adjacent to the Reception Foyer. The garden will be landscaped during the final stages of the building refurbishment, and low-growing native plants will be used around the artwork.

We recommend artists visit the site to view the artwork location in person before finalising their design.

As the area is currently a Building Site, all access must be supervised.

Entry will be from Mrs Macquaries Road through the front gates to Reception.

There will be two timeslots available for artist visits:

1. Tuesday 20 February: 2 – 3.30pm
2. Thursday 22 February: 10.30am – 12noon



EOI REQUIREMENTS

To ensure you meet the selection criteria, please use the EOI form on our website: www.botanicgardens.nsw.gov.au/First-Nations-Art-Project

You must include:

- 1. Contact Details -**
Name, mobile, email, postal address, ABN (if applicable).
- 2. Design Concept -**
Hand-drawn or digitally rendered designs are accepted.
Please include a supporting statement describing your concept.
- 3. Connection to Country -**
Your connection to Countries & Communities of the Sydney region.
- 4. Artistic Experience -**
One-page CV or website outlining your experience and achievements.
- 5. Availability -**
Ensure you are available for an interview on 14 March 2024 if you are shortlisted. Alternate dates cannot be arranged.

You must be able to meet the project timeline to deliver the artwork on time if your design is selected.



SUBMITTING THE EOI

EOI submissions must be received by the deadline:
5pm Friday 8 March 2024.

All EOI submissions should be emailed to:
sophie.daniel@botanicgardens.nsw.gov.au

The EOI form can be found on our website:
www.botanicgardens.nsw.gov.au/First-Nations-Art-Project

For any queries, please contact Sophie Daniel, BGoS Manager
Interpretation and Placemaking by email:
sophie.daniel@botanicgardens.nsw.gov.au



TERMS AND CONDITIONS

Botanic Gardens of Sydney reserves the right to accept or decline any submission.

The Selection Panel's decisions are final, and no communications will be entered into regarding an unsuccessful EOI submission.

Unsuccessful artists will be advised by email.

Botanic Gardens of Sydney make no claim to intellectual property rights for any unsuccessful submissions. We will not utilise expression of interest materials for any other project.

Botanic Gardens of Sydney will take all care in relation to the safekeeping of submissions. All submissions from unsuccessful artists will be deleted within six weeks of the completion of the EOI process.



**BOTANIC
GARDENS
OF SYDNEY**

Thank You

botanicgardens.org.au



Royal Botanic Garden Sydney | Australian Botanic Garden Mount Annan | Blue Mountains Botanic Garden Mount Tomah | The Domain Sydney | Australian Institute of Botanical Science